



LEGEND

RECENT
Alluvial - sand, silt and gravel

TERTIARY
Laterite - ferruginous indurated laterite
Terrestrial unconsolidated sediments - quartz rich gravels

PERMIAN
Undifferentiated sediments - flat lying

LOWER PALAEZOIC
Sandstone - occasional grit and shale horizons
Limestone - (22) Gordon limestone, dark grey to black fine grained/
(23) whitish medium grained, stylonitic limestone with thin siliciclastic horizons

Calcareous mudstone
Calcareous sandstone/siltstone sequence
Graphitic shale
Cobble conglomerate - siliceous clasts/matrix clasts

CABBAGE TREE FORMATION
Upper transition beds - fine to medium grained calcareous sandstones
Lower transition beds - including pebble conglomerate siltstones
Basal limestone - whitish fine grained, stylonitic in part, occasional siliciclastic horizons
Cobble (chromiferous) conglomerate

Shale siltstone sequence - carbonaceous in part

INTRUSIVE
Keratophyre
Jurassic dolerite
Basaltic dyke

Strike and dip of bedding
Strike and dip of foliation
Diamond drillhole
Shaft
Adit
Coastline
Outcrop
Sub-outcrop

Geological contact - position accurate
Geological contact - position inferred
Fault - dip direction indicated

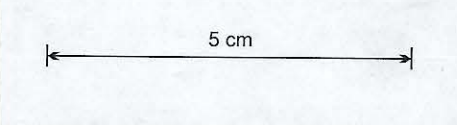
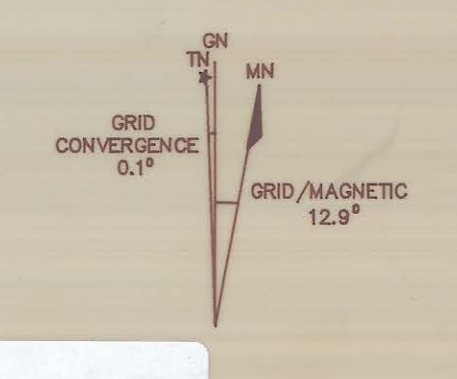
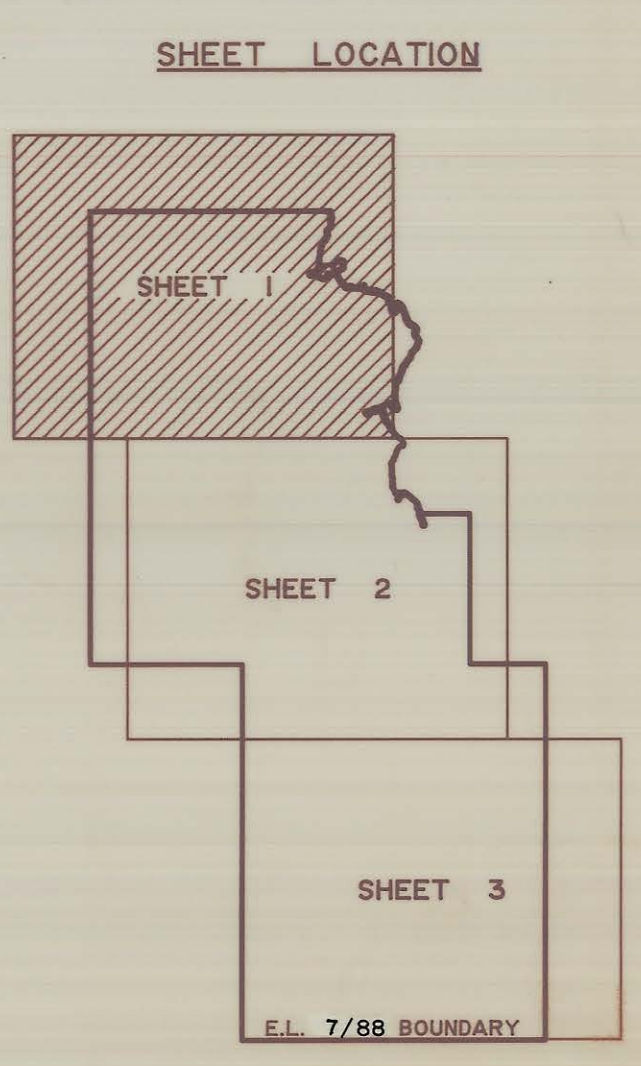

Plate 6

BEACONSFIELD OPERATIONS PTY. LIMITED

BEACONSFIELD EL 7/88

FACT & INTERPRETED GEOLOGY Sheet 1

SCALE 1 : 5000

DRAWN BY :
DRAFTSMAN : T.G.D.S.
DATE : Dec. '87
REVISIONS :
FILE No.
Dwg No. BF 89-8

BEAC / 0236/4

BF89-8